

NOTE:
FLORIDA FIRE PREVENTION CODE (FFPC) 7th EDITION EFFECTIVE
DECEMBER 31, 2020 WITH BROWARD COUNTY AMENDMENTS
WHICH INCLUDES NFPA 101, 2018 EDITION, NFPA 1, 2018 EDITION
AND STATE STATUTES 2019 EDITION.

NOTE:
REVIEW AND APPROVAL BY THE AHJ SHALL NOT RELIEVE THE
APPLICANT OF THE RESPONSIBILITY OF COMPLIANCE WITH
THE THIS CODE PER NFPA 1:1.14.1

NOTE:
THE BUILDING IS FULLY FIRE SPRINKLED. ANY REQUIRED SPRINKLER
HEAD RELOCATION TO BE PROVIDED BY SHOPDRAWINGS. TO BE
COORDINATED BY THE CONTRACTOR.

NOTE:
ALL EXISTING FIRE ALARMS AND DEVICES AREA EXISTING TO REMAIN

NOTE:
ALL DOORS IN THE MEANS OF EGRESS SHALL BE SINGLE ACTION
RELEASE AND SHALL NOT REQUIRE THE USE OF A KEY, TOOL OR
SPECIAL KNOWLEDGE TO OPEN FROM EGRESS SIDE SHALL COMPLY WITH NFPA

NOTE:
FIRE EXTINGUISHERS SHALL BE MOUNTED AT 48" A.F.F.

NOTE:
FIRE EXTINGUISHERS SHALL BE CURRENTLY DATED AND TAGGED BY LICENSED FIRE
EQUIPMENT COMPANY.

NOTE:
ALL EMERGENCY LIGHTS AND EXIT SIGNS MUST BE WORKING ON EMERGENCY BATTERY BACK-UP

NOTE:
THE NUMERICAL ADDRESS WILL BE PROVIDED ON ALL EXTERIOR DOORS AS PER CITY ORDINANCE
52.10 WITH 6 INCH NUMBERS, WEATHER PROOF AND CONTRASTING COLORS. IF THE ADDRESS
IS TO BE PLACED ON A WINDOW THE NUMBERS SHALL BE "WHITE" IF THEY ARE TO BE ON
A LIGHT COLOR BACKGROUND THEY SHALL BE BLACK.

NOTE:
ALL FURNITURE MUST BE PLACED AT THE TIME OF FIRE INSPECTION.

NOTE:
ALL CEILING TILES MUST BE IN PLACE AND REPLACED ALL BROKEN TILES AT THE
TIME OF FIRE INSPECTION.

INTERIOR WALLS AND CEILING FINISHES:
INTERIOR WALLS AND CEILING FINISH COMPLYING WITH 10.2.3 SHALL BE
CLASS "A" OR CLASS "B" IN ALL CORRIDORS AND LOBBIES AND SHALL
BE CLASS "A" IN ENCLOSED STAIRWAYS. SHALL ALSO BE CLASS "A" OR "B"
IN GENERAL ASSEMBLY AREAS.

INTERIOR FLOOR FINISHES:
INTERIOR FLOOR FINISH COMPLYING WITH 10.2.7 SHALL BE CLASS I OR CLASS II
IN CORRIDORS AND EXITS.

CLASS "A" INTERIOR WALL AND CEILING FINISH:
FLAME SPREAD 0-25 SMOKE DEVELOPMENT 0-450

CLASS "B" INTERIOR WALL AND CEILING FINISH:
FLAME SPREAD 26-75 SMOKE DEVELOPMENT 0-450

CLASS "C" INTERIOR WALL AND CEILING FINISH:
FLAME SPREAD 76-200 SMOKE DEVELOPMENT 0-450

ALL INSULATION MATERIAL TO HAVE A FLAME SPREAD INDEX
OF NOT MORE THAN 25 AND A SMOKE DEVELOPMENT INDEX OF NOT MORE THAN 450

FABRICS AND FILMS USED FOR DECORATIVE PURPOSE, ALL DRAPERIES AND CURTAINS
AND SIMILAR LOOSELY HANGING FURNISHINGS SHALL MEET THE FLAME PROPAGATION
PERFORMANCE CRITERIA CONTAINED IN NFPA-701, STANDARD METHOD OF FIRE TEST
FOR FLAME PROPAGATION OF TEXTILES AND FILMS (NFPA-101.12.2.7.4 AND 10.3.1

- NOTE:
- FIRE CODES IN EFFECT:
FLORIDA FIRE PREVENTION CODE (FFPC) SIXTH EDITION EFFECTIVE 12-31-2017 WITH BROWARD COUNTY AMENDMENTS,
WHICH INCLUDE NFPA 101, 2015 EDITION, NFPA 1 2015 EDITION AND STATE STATUTES 2017 EDITION.
 - FIRE EXTINGUISHERS SHALL HAVE A MINIMUM RATING OF 2A, 20BC MOUNTED 48" A.F.F. TO THE TOP
OF THE HANDLE. TRAVEL DISTANCE SHALL NOT EXCEED 75 FEET, AND THEY ARE TO BE CURRENTLY
TAGGED BY A LICENSED FIRE EQUIPMENT COMPANY.
 - ALL JOINTS AT THE FIRE RATED PARTITIONS
ARE TO BE PROTECTED BY AN APPROVED FIRE RESISTANT JOINT SYSTEM
TO RESIST ONE HOUR RATING. THE FIRE RESISTANT JOINTS SHALL BE SECURLY
INSTALLED IN OR AT THE JOINT FOR ITS ENTIRE LENGTH, SO AS NOT TO DISLODGE.
 - ADDITIONAL EXIT AND EMERGENCY LIGHTS MAY BE REQUIRED
BY THE FIELD FIRE INSPECTOR AT THE TIME OF THE FIRE FINAL.

PROJECT TABULATION		
DISCIPLINE	REQUIRED	PROVIDED
EXISTING BUILDING TYPE	EXISTING TYPE VB UNPROTECTED NON SPRINKLED	
OCCUPANCY	NEW BUSINESS (GROUP "B")	
SQUARE FEET ADDITION	312.00 S.F.	
TRAVEL DISTANCE	200 FT MAX	SEE LIFE SAFETY PLAN
INTERIOR FINISH	SEE NOTE THIS SHEET	
TENANT SEPARATION	EXISTING	EXISTING
OCCUP. LOAD	1/100 S.F.	3.12 PEOPLE
EXIT REQUIREMENT	0.2"/PERSON 1.52 LIN. FT.	13.98 LIN FT.

BUILDING IS NOT SPRINKLED

EXIT REQUIREMENTS:
EGRES WIDTH AS PER TABLE 1004 FBC
AND 5-3.1 LIFE SAFETY CODE 0.2
4 X 0.2 / 12 = 0.06 LIN. FT. EXIT REQUIRED
5.66 LIN. FT. EXIT PROVIDED

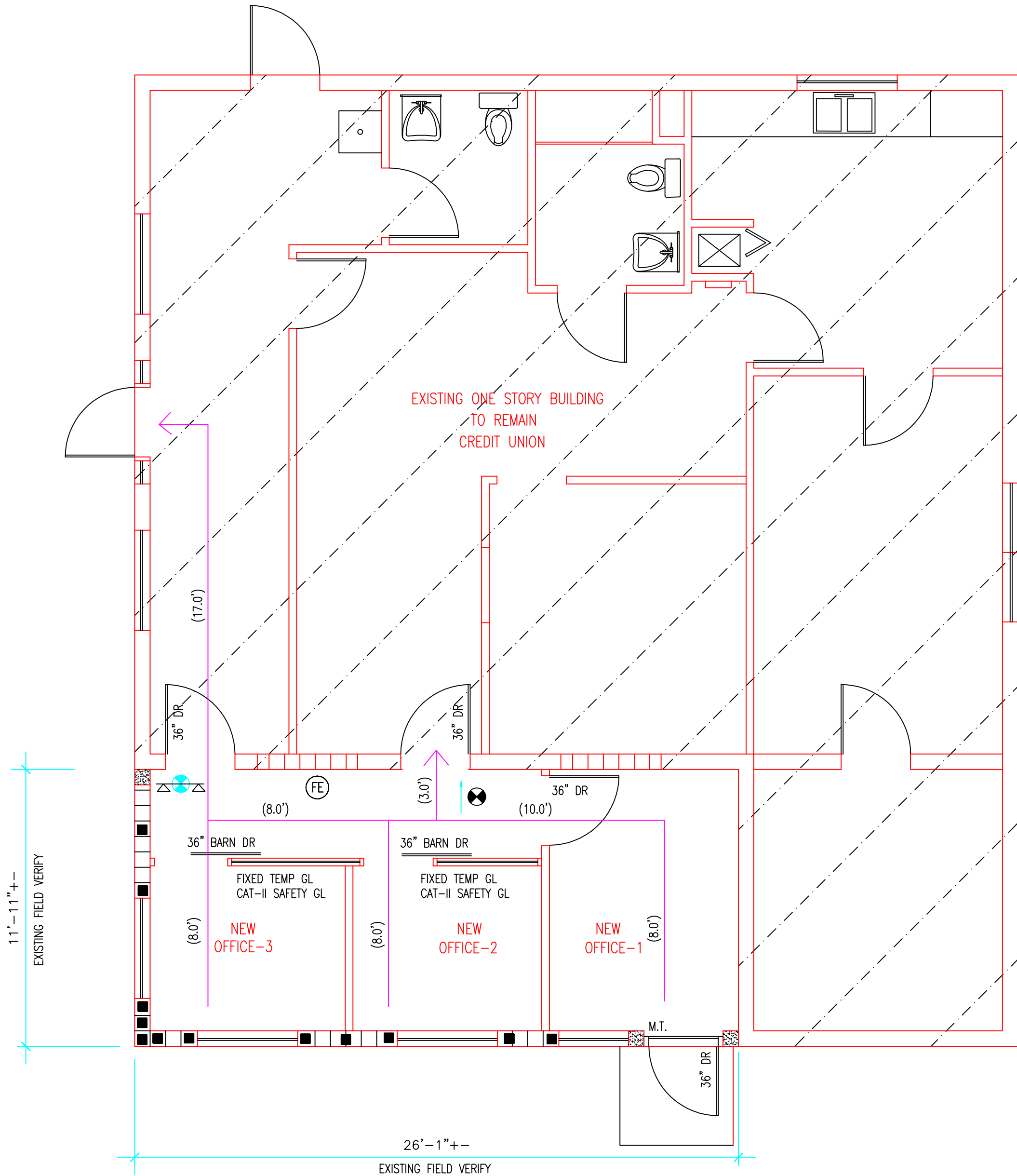

N

LIFE SAFETY PLAN

SCALE: 1/4"=1'-0"

ALL DIMENSIONS ARE TO BE FIELD VERIFIED

F.B.C. 2020 SEVENTH EDITION

CONST TYPE VB

OCCU. GROUP "B"

ALTERATION LEVEL-2

CODES IN EFFECT:

FLORIDA PLUMBING CODE 7th EDITION 2020

FLORIDA ACCESSIBILITY CODE 7th EDITION 2020

FLORIDA BUILDING CODE 7th EDITION 2020

FLORIDA EXISTING BUILDING CODE 7th EDITION 2020

LEGEND

EXIT LIGHT FIXTURE WITH BATTERY BACH-UP
WIRED TO UNSWITCHED LEG NOT MORE THAN 5W PER FACE

COMBO EMERGENCY / EXIT LIGHT FIXTURE WITH BATTERY BACH-UP
NOT MORE THAN 5W PER FACE

FIRE EXTINGUISHER

Miguel F de Diego
Digitally signed by Miguel F de Diego
Date: 2023.02.16 15:54:40 -05'00'

2-15-2023

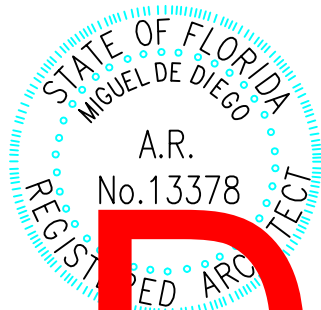

Miguel de Diego
ARCHITECT P.A.
AA-26001641
1657 TYLER STREET SUITE 107 HOLLYWOOD, FLORIDA 33020
PH. (954) 926-3358

CHECKED
DRAWN
DATE 2-15-2023
COMM. NO. 22-174

NEW ADDITION
FOR
420 NE 19th AVE.
POMPANO BEACH, FLORIDA

ALL DESIGN, DRAWINGS, REPORTS,
SPECIFICATIONS, COMPUTER FILES, FIELD
DATA, NOTES AND ANY OTHER DOCUMENTS
HEREIN ARE THE PROPERTY OF MIGUEL F. DE DIEGO
INSTRUMENTS OF SERVICE SHALL REMAIN
THE PROPERTY OF THE ARCHITECT AND IS
NOT TO BE REPRODUCED, COPIED, REPRODUCED,
ALTERED IN WHOLE OR IN PART, IT IS ONLY
TO BE USED FOR THE PROJECT AND SITE
AND NO PART THEREOF SHALL BE USED FOR
ANY OTHER PROJECT OR PURPOSE.
THE ARCHITECT SHALL RETAIN ALL COMMON
LAW COPYRIGHT AND OTHER RESERVED
WRITTEN DIMENSIONS SHALL HAVE
PRECEDENCE OVER SCALE.